

## Driver Displays (DDS enabled)

Use the **▲** or **▼** button to scroll up/down to show one of the displays below. For more details on Driver Displays, please visit [www.se5000.com](http://www.se5000.com).

**Time Left to Drive**  
Time left driving until next activity      Next activity (start of daily rest)

Time left driving view is shown      How long the resting time must be to get more driving time

**Time Left to Rest**  
Driver's current activity (resting)      Time Left Resting until more driving time is available

Co-driver's current activity (available)      Drive time available after this break/rest time

**Overview**  
Driving time since last break/rest      Driver's accumulated break time

Driver's current activity      Co-driver's current activity      Duration of the co-driver's activity      Local time

**Working Time**  
Indicate that driver information is shown

Working time since last break      Daily working time      Daily break time      Weekly working time

**Speed & Odometer**  
Type of card inserted in tray 1      Current speed

Type of card inserted in tray 2      Odometer

SE5000-8, 103927P/01R01 EN

## Driver Quickguide

### Insert your card

① Press and hold the button marked **1** (if you are the driver) until a card tray pops out. Press **2** if you are the co-driver.

② Insert the card with the chip facing upwards.

③ Press the card in place in the tray.

④ Close the tray by pushing it gently forward.

The vehicle must be stationary when you insert or withdraw a card.

### Withdraw (eject) your card

① Press and hold the button marked **1** if you are the driver. Press **2** if you are the co-driver.

② The display will ask you to select end country. Use arrow buttons to move to your end country. Confirm by pressing the **OK** button.

③ The tray will open. Press the card underneath through the opening in the tray and the card will pop out.

STONERIDGE - EVERY ANGLE COVERED

### Manual Entries

During the manual entries procedure you can use the **◀** button to move back to previous selection or backwards in display menu before confirming.

1. Insert the driver card and wait until the tachograph processes the driver card data. The display shows the name of the card holder, the date and time for the last card withdrawal and local time/UTC off-set.

2. Continue with *Rest until now?* YES or NO. Note: After time out (1 or 20 min), manual entries are no longer possible.

#### Rest until now? YES

*Scenario:* The driver card was withdrawn at the end of the last working day and inserted when the new working day started.

1. Confirm with YES.
2. Select and confirm *End country* for the last working day.
3. Select and confirm *Begin Country* for the current working day. Note! Step 2 and 3 will not be used if the time between card withdrawals and insertion is less than nine hours.
4. Confirm if you want a printout or not.
5. Select and confirm YES to confirm the entries or NO to clear or modify entries.
6. You are now ready to drive.

### Rest until now? NO

*Scenario:* You arrived at 15.23, 23/11 and withdrew the card. You performed other work until 17:00 and rested until 20.37, 23/11 when you inserted the card again.

1. Select and confirm NO.
2. Confirm *Add manual entries* with YES.
3. The following is displayed. The date and local time is shown for the last card withdrawal.
4. Select and confirm activity *Work*. Adjust and confirm the date when the activity ended (23/11). Default time is set to insertion time. Adjust and confirm the time (hour and minute) to when the activity ended.
5. The following is displayed.
6. Select and confirm activity *Rest*. In this example nothing needs to be adjusted.
7. Continue with step 4 in chapter *Rest until now?* YES. For full details on the SE5000-8 functionality we refer to the Driver & Company Manual or visit [www.SE5000.com](http://www.SE5000.com)



# Change Paper Roll

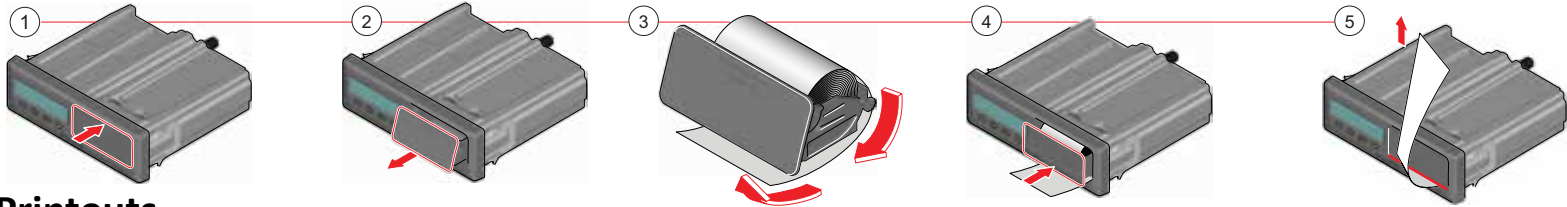

# Printouts

**Note!** For excluded parts, see the driver card print out.

	<b>24h Driver Card</b>
▼ 25/04/2017 08:04 (UTC)	Printout date and time (UTC time)
24h▼	Type of printout (24h, card)
○ Smith Bob ○S /10007001130590 0 0	Card holder's name, card identification and expiration date
31/12/2018 - GEN 2	
A YV1AA8843M10123456 S/CAR321	Vehicle identification and registration number
B Stoneridge Electronics 900588RA/37R01 GEN 2	Tachograph manufacturer and part number
T Bil&lastvagnsservice T S / 0 0 0 1 2 1 2 0 T 23/12/2016	Responsible workshop for last calibration and date
□S / 0 0 9 2 4 5 3 9 □ 12/04/2017 08:23 □▼↑	Last control the inspected driver has been subjected to
18/04/2017 67	Enquiry date and daily card presence counter
A S / CAR321 26 007 km	Vehicle registration number and odometer value at card insertion.
H 00:00 07h32	Activities with driver card inserted, start and duration time.
○ 06:30 ---△→-----	Vehicle odometer and distance traveled (since card inserted) at card withdrawal.
○ 06:31 00h06	
H 06:37 00h55	
○ 07:32 ---→△-----	
○ 07:32 04h01	
H 11:33 00h45	
○ 12:28 00h32	
26 305 km 38 km	
---Σ-----	
●▶10:29 S	Time, position and odometer value at start of daily period
lon +018°01.0'	
lat +58°22.2'	
07:29	
26 007 km	
▶●12:41 S	Time, position and odometer value at end of daily period
lon +018°01.0'	
lat +59°22.2'	
17:43	
26 305 km	
⊗10:32	Time, position and odometer value after 3 hours of accumulated driving
lon +018°01.0'	
lat +59°22.2'	
10:31	
26 223 km	
○ 04h33 298 km	Activities totals for a card, and total driving distance
× 00h00 □ 00h00	
H 08h17 ? 00h00	
○ 00h00	
!⊗(02) 23/01/2017 12:34	Last five events and faults from the driver card
!11 00h02	
>> (02) 27/02/2017 13:53	
!05 00h15	
×⊗(02) 01/03/2017 08:01	
!08 00h01	
!⊗(02) 23/01/2017 12:34	Last five events and faults from the VU, vehicle unit
!11 ( 1) 00h02	
○S /10007001130590 0 0	
Timeout 13243	
.....	Control place
.....	Controller's signature
.....	Driver's signature

	<b>24h Vehicle Unit (VU)</b>
▼ 18/04/2017 08:08 (UTC)	Printout date and time (UTC time)
24h▼	Type of printout (24h, VU)
○ Smith Bob ○S /10007001130590 0 0	Card holder name, card identification and expiration date
31/12/2018 - GEN 2	
05/02/2018	Enquiry date for the printout and vehicle odometer at 00:00 and 24:00
102 075 - 102 809 km	
○ Smith Bob ○S /10007001130590 0 0	Previous vehicle registration number, date and time of card withdrawal from previous vehicle. Odometer value at card insertion. M = Manual entries of driver activities.
31/12/2018 - GEN 2	
A S / CAR321	Activities with driver card inserted, start and duration time.
05/02/2018 17:49	Vehicle odometer and distance traveled (since card inserted) at card withdrawal
102 075 km	
H 00:00 07h32	
○ 07:30 03h10	
H 10:40 00h46	
× 11:26 00h10	
○ 11:36 03h12	
H 14:48 00h55	
○ 15:43 02h00	
102 809 km 734 km	
---Σ-----	VU summary of periods without card in driver slot
10:30 S	Time, position and odometer value at start of daily period
lon +018°01.1'	
lat +57°22.2'	
10:30	
102 075 km	
▶●10:32 S	Time, position and odometer value at end of daily period
lon +018°01.0'	
lat +57°22.3'	
10:32	
102 076 km	
⊗10:3U	Time position and odometer value after 3 hours of accumulated driving
lon +018°01.0'	
lat +59°22.2'	
10:29	
102 365 km	
⊗14:2G	Activities totals for a card, and total driving distance
lon +012°02.8'	
lat +57°40.1'	
14:26	
102 635 km	
○ 08h?? 734 km	
× 00h10 □ 00h00	
H 01h45 ? 00h00	
○ Smith Bob ○S /10007001130590 0 0	VU daily summary per driver
○S /10007001130590 0 0	Driver name and card identification
●▶10:30 S	Time, position and odometer value at start of daily period
lon +018°01.1'	
lat +57°22.2'	
07:29	
102 075 km	
▶●10:32 S	Time, position and odometer value at end of daily period
lon +018°01.0'	
lat +57°22.3'	
10:32	
102 076 km	
⊗13:31	Time, position and odometer value after 3 hours of accumulated driving
lon +018°21.0'	
lat +58°22.2'	
13:31	
102 289 km	
○ 03h30 270 km	Activities totals for this driver, and total driving distance
× 00h31 □ 00h00	
H 00h00	
○ 00h00	
!⊗(U2) 28/01/2018 08:3U	Events and/or faults stored or ongoing in a VU
!11 ( 1) 00h23	
○S /10007001130590 0 0	
.....	Control place
.....	Controller's signature
.....	From time
.....	To time
.....	Driver's signature